

Pilaretes (estrutura pontaletada)

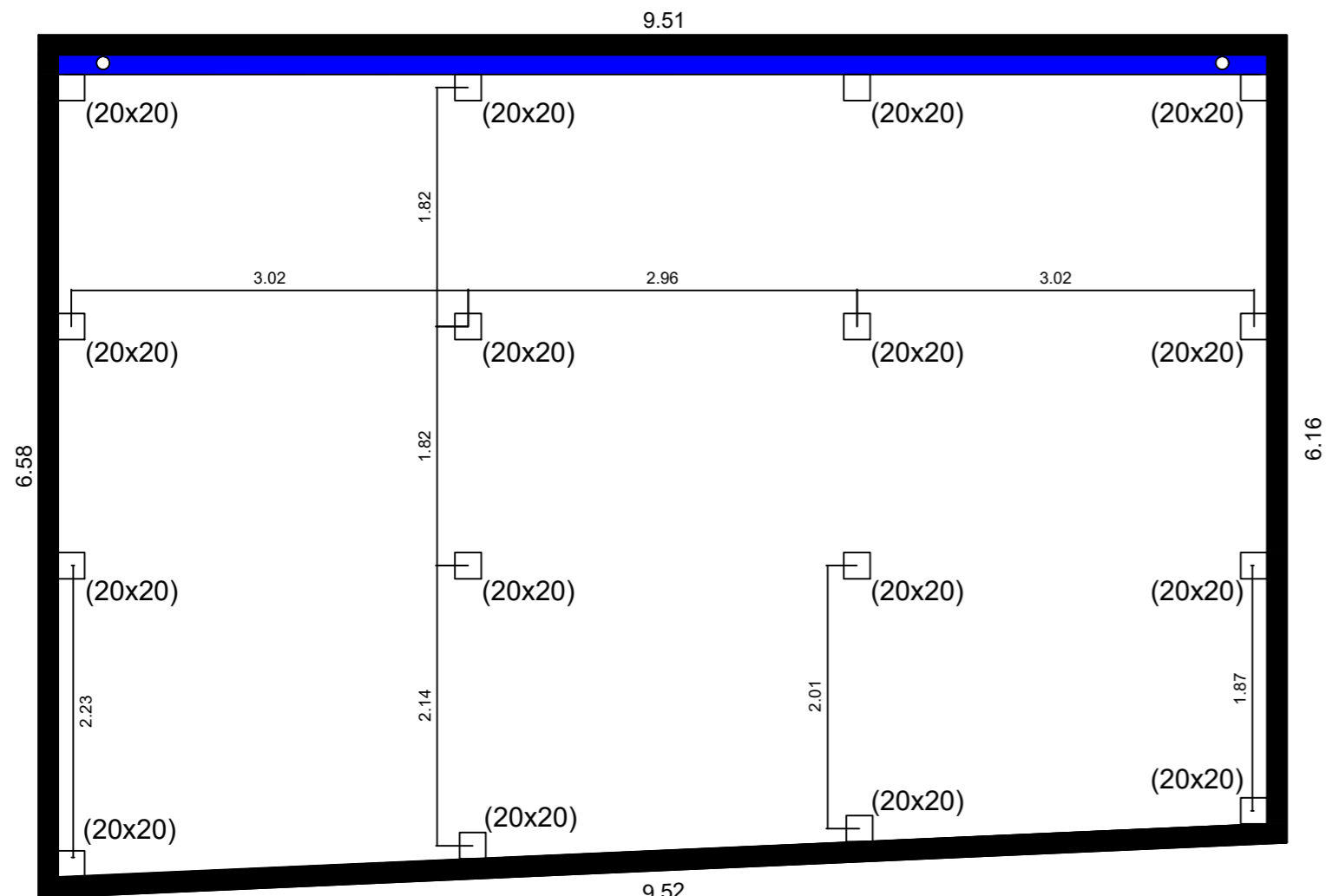

ESCALA 1:50

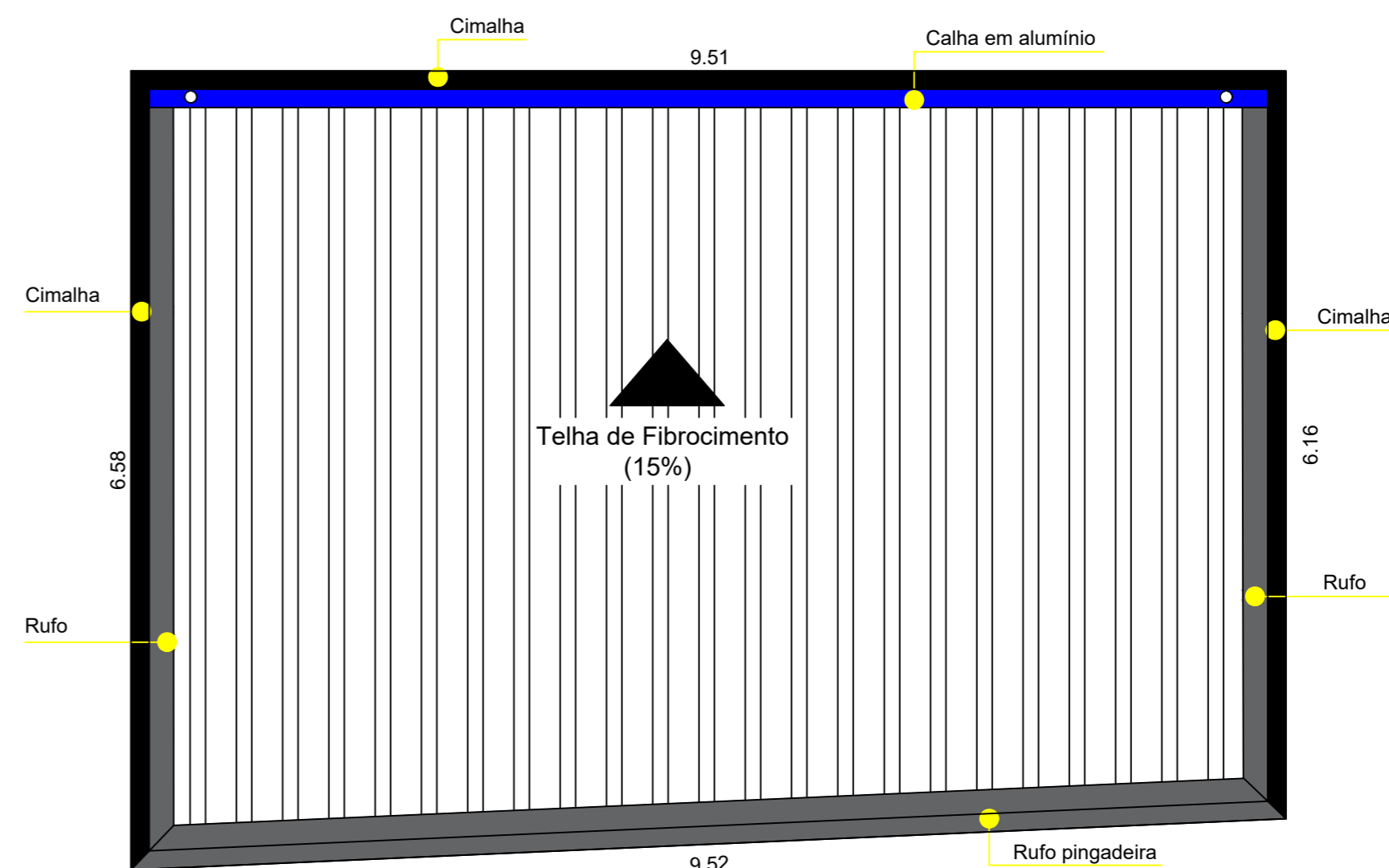

ESCALA 1:50

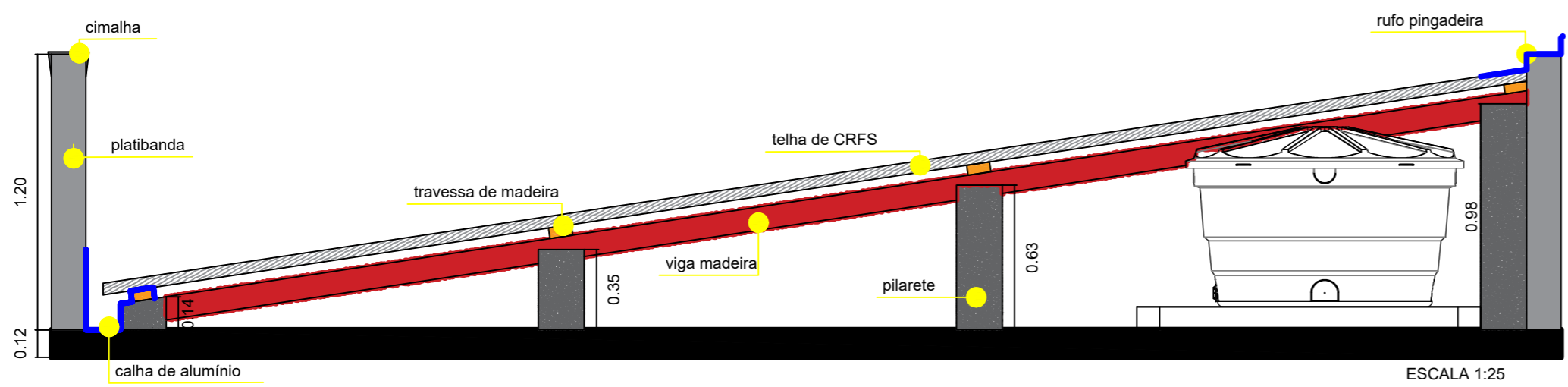

ESCALA 1:25

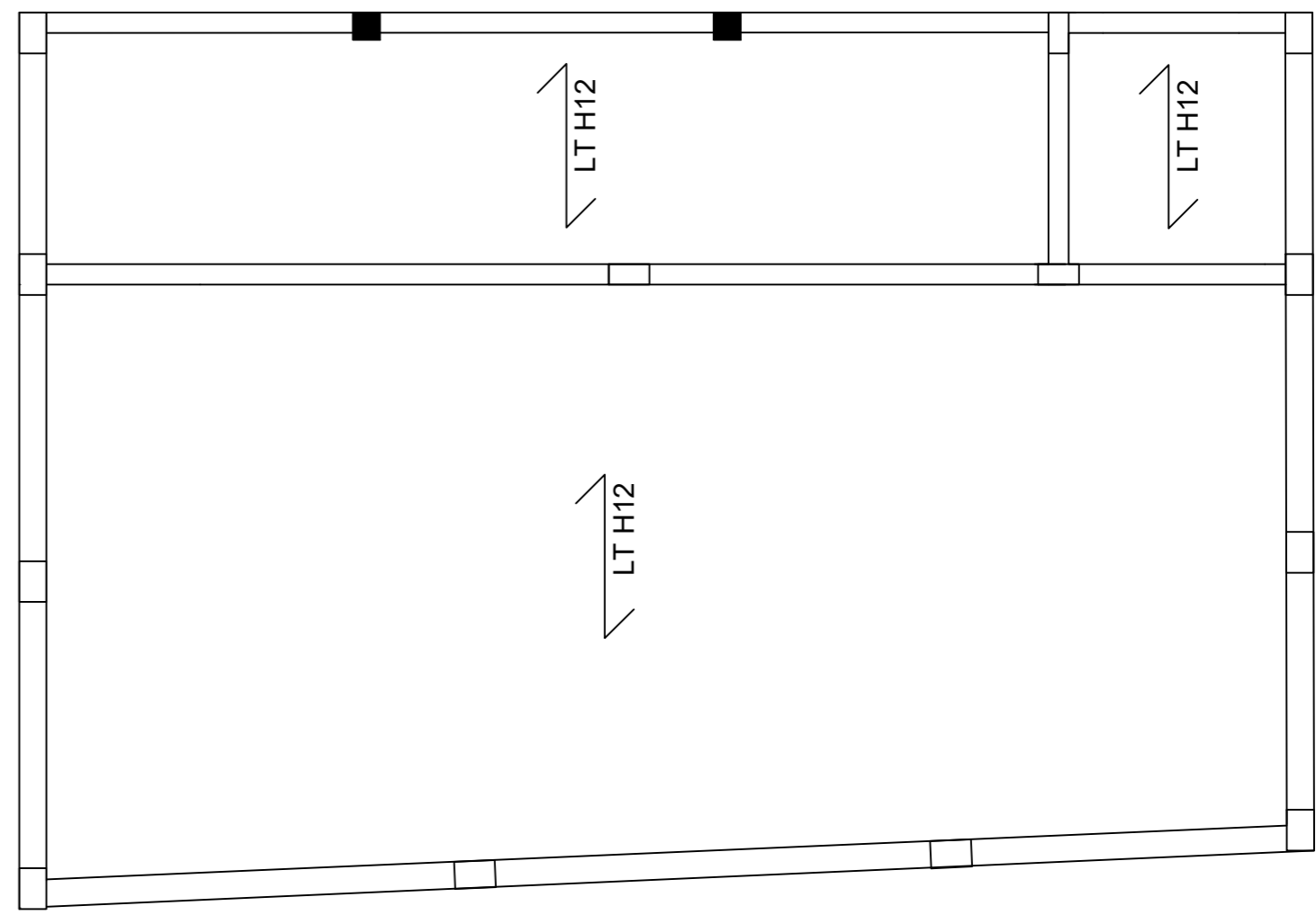

ESCALA 1:50

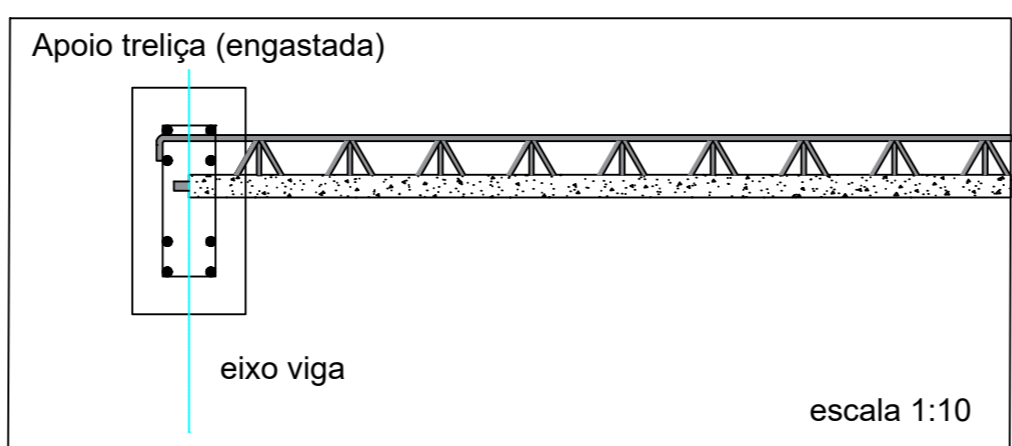

escala 1:10

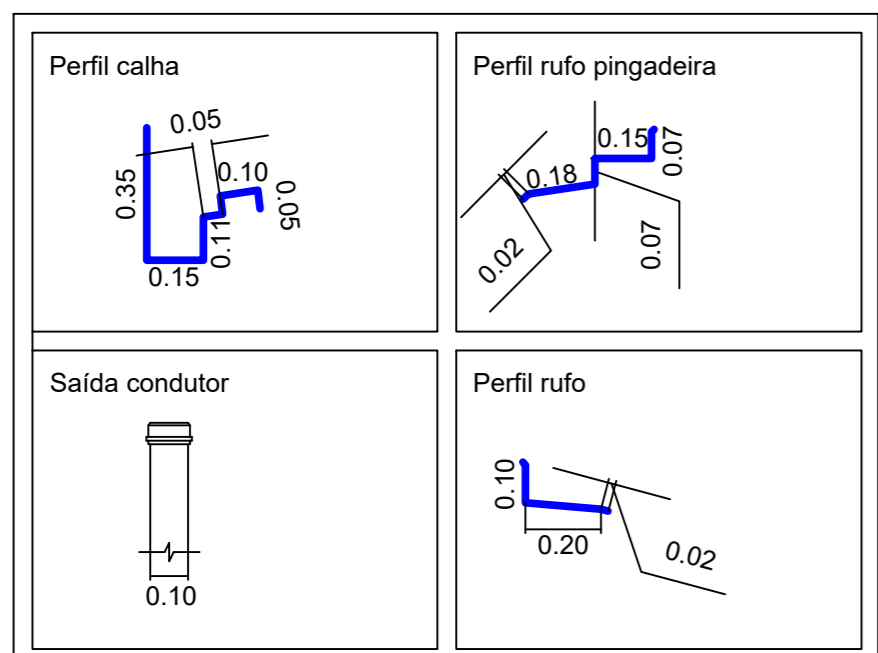

ESCALA 1:20

PROJETADO POR:
GUSTAVO DE OLIVEIRA REZENDE

DES.:
PRJ.:
RESP. TECN.:
ASS.:

CREA:
5070032308

RRT:

PREFEITURA MUNICIPAL DE ILHA COMPRIDA
ESTÂNCIA BALNEÁRIA
AVENIDA BEIRA MAR 11000 - CEP 11925-000

OBRA: REFORMA E AMPLIAÇÃO CÂMARA MUNICIPAL

ENDEREÇO: Av. Beira Mar nº:11.476 - Balneário Icarai

ASSUNTO: PROJETO COBERTURA (COZINHA)

Nº DES.:
FL.: ÚNICA
REV.: 01
ESCALA: INDICADA